

Primary Usage
Reference No.
Sign. and date
Copy inv. No.
Repl. Inv. No.
Sign. and date
Orig. Inv. No.

Ductile Cast Iron Grating 8" (Mesh)

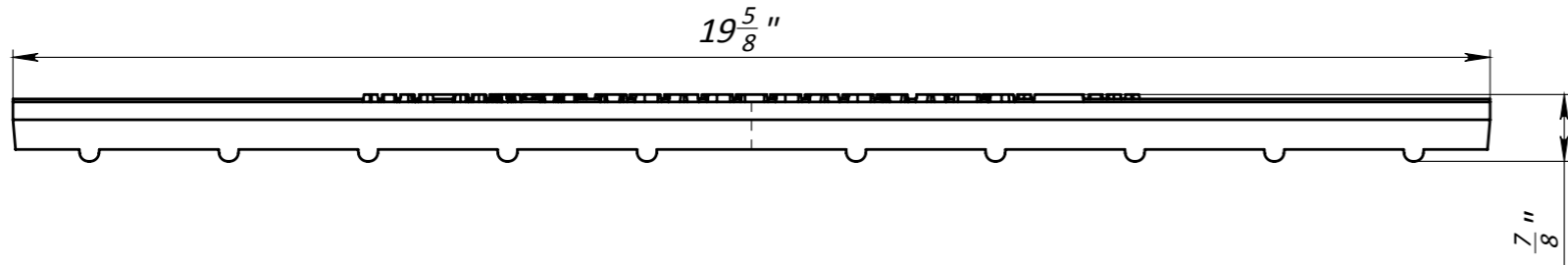
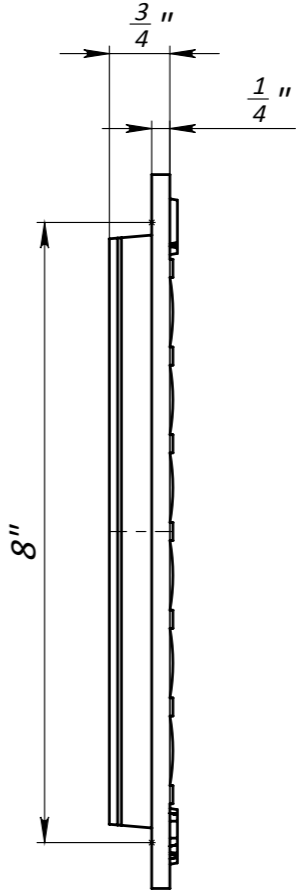
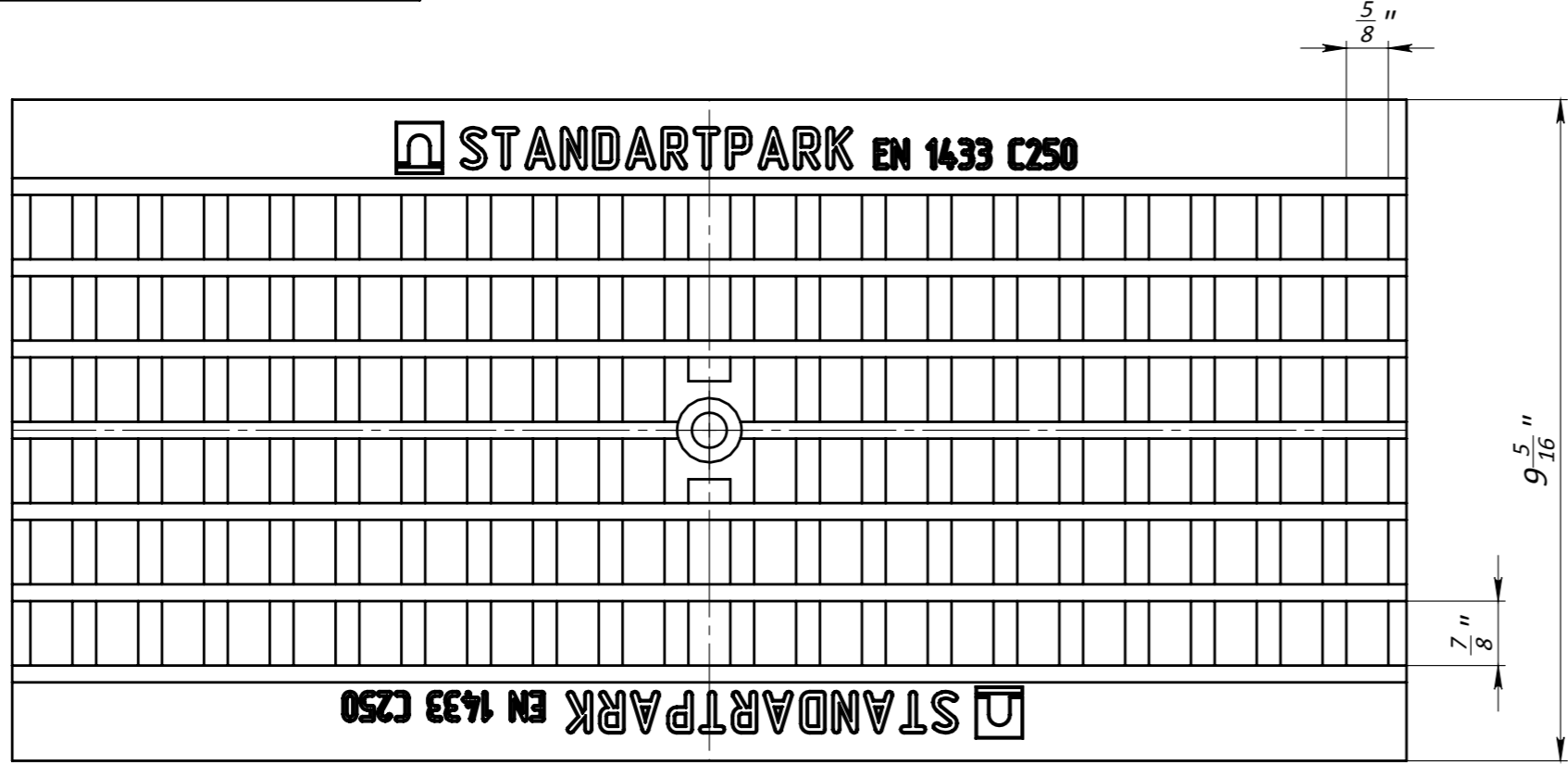

- 1. Area of water intake slots 66,7 sq in
- 2. Deviation of the actual weight of the nominal can be up to 10%

					Art.	25403		
					Ductile Cast Iron Grating 8" (Mesh)			
Rev.	Sheet	Doc. No.	Sign.	Data	<b>NP-DG 25403</b> Load Classes A-C	Let.	Weight (lb)	Scale
				04.08.16			14.54	1:2.5
						Sheet	Sheets 1	
					Ductile Cast Iron (powder painting)			